



# TRANSFER AUGER

## 9-INCH POLY MODEL

## OPERATION MANUAL

### ORIGINAL INSTRUCTIONS



Read this manual before using product. Failure to follow instructions and safety precautions can result in serious injury, death, or property damage. Keep manual for future reference.

Part Number:30955 R0

Revised: 26/8/15



This product has been designed and constructed according to general engineering standards<sup>a</sup>. Other local regulations may apply and must be followed by the operator. We strongly recommend that all personnel associated with this equipment be trained in the correct operational and safety procedures required for this product. Periodic reviews of this manual with all employees should be standard practice. For your convenience, we include this sign-off sheet so you can record your periodic reviews.

[illegible]

- a. Standards include organizations such as the American Society of Agricultural and Biological Engineers, American National Standards Institute, Canadian Standards Association, International Organization for Standardization, EN Standards, and/or others.



# TABLE OF CONTENTS

<b>1. Introduction .....</b>	<b>5</b>
1.1. Intended Use .....	6
<b>2. Safety .....</b>	<b>7</b>
2.1. Safety Alert Symbol and Signal Words .....	7
2.2. Basic Operator Safety, Responsibilities, & Qualifications .....	7
2.3. Rotating Flighting .....	8
2.4. Work Area Safety .....	8
2.5. Transport Safety .....	8
2.6. Drives and Lockout Safety .....	9
2.6.1. Hydraulic Power Safety .....	9
2.7. Personal Protective Equipment .....	10
2.8. Safety Equipment .....	10
2.9. Safety Decals .....	11
2.9.1. Decal Installation/Replacement .....	11
2.9.2. Safety Decal Locations and Details .....	11
<b>3. Operation .....</b>	<b>13</b>
3.1. Operating Safety .....	13
3.2. Transport Procedure .....	13
3.3. Placement Procedure .....	13
3.4. Transfer Spout Handle .....	14
3.5. Start-up and Break-In .....	14
3.6. Operation - Hydraulic Drive .....	14
3.7. Emergency Shutdown / Full-Tube Restart .....	15
3.8. Adjustable Auger Balance .....	15
3.9. Shutdown .....	16
3.10. Storage .....	16
<b>4. Maintenance .....</b>	<b>19</b>
4.1. Maintenance Safety .....	19
4.2. Maintenance Schedule .....	19
4.3. Fluids & Lubricants .....	19
4.4. Maintenance Procedures .....	20
4.4.1. Visual Inspection .....	20
4.4.2. Clean Machine .....	20
4.4.3. Inspect Hydraulic Hose & Coupler .....	21
<b>5. Troubleshooting .....</b>	<b>23</b>
<b>6. Appendix .....</b>	<b>25</b>
6.1. Specifications .....	25
Warranty .....	27





# 1. Introduction

Thank you for purchasing Westfield Transfer Auger. This equipment will allow safe and efficient operation when you read and follow all of the instructions contained in this manual. With proper care, your Transfer Auger will provide you with many years of trouble-free operation.

Keep this manual handy for frequent reference and to review with new personnel. A sign-off form is provided on the inside front cover for your convenience. If any information in this manual is not understood or if you need additional information, please contact your local distributor or dealer for assistance.

This manual should be regarded as part of the equipment. Suppliers of both new and second-hand equipment are advised to retain documentary evidence that this manual was provided with the equipment.

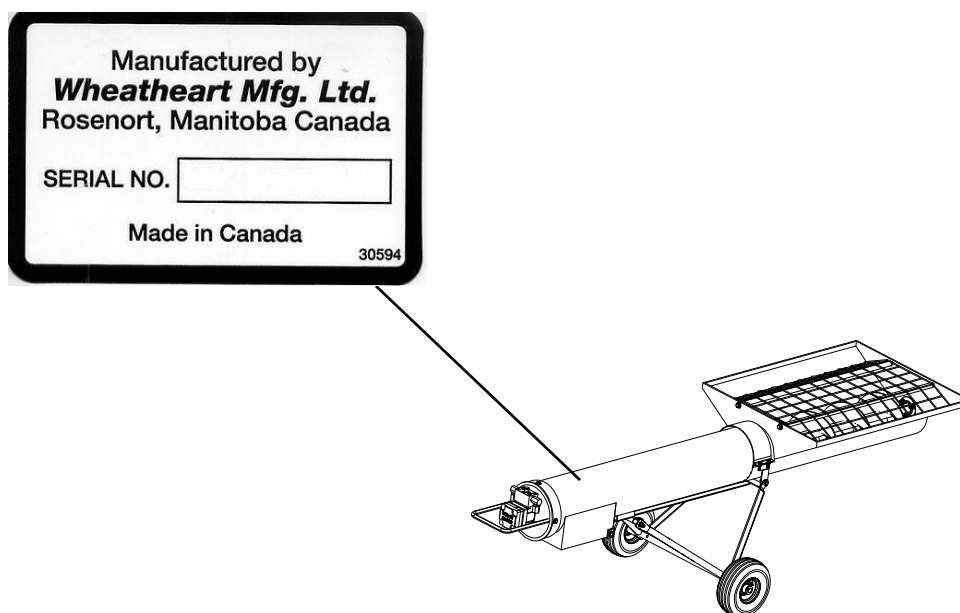

Always give your dealer the serial number on your equipment (shown above) when ordering parts or requesting service or other information. Please record this information in the table below for easy reference.

<b>Model Number</b>	
<b>Serial Number</b>	
<b>Date Received</b>	

## 1.1. Intended Use

---

This equipment is designed solely for use in customary agricultural or similar operations. Use in any other way is considered as contrary to the intended use. Compliance with and strict adherence to the conditions of operation and maintenance as specified by the manufacturer, also constitute essential elements of the intended use.

This equipment should be operated, maintained, serviced, and repaired only by persons who are familiar with its particular characteristics and who are acquainted with the relevant safety procedures.

Accident prevention regulations and all other generally recognized regulations on safety and occupational medicine must be observed at all times.

Any modifications carried out to this equipment may relieve the manufacturer of liability for any resulting damage or injury.

Do not use the transfer auger for:

- moving material other than dry, free flowing grains

## 2. Safety

### 2.1. Safety Alert Symbol and Signal Words

---



This safety alert symbol indicates important safety messages in this manual. When you see this symbol, be alert to the possibility of injury or death, carefully read the message that follows, and inform others.

**SIGNAL WORDS:** Note the use of the signal words **DANGER**, **WARNING**, **CAUTION**, and **NOTICE** with the safety messages. The appropriate signal word for each message has been selected using the definitions below as a guideline.



**DANGER** Indicates an imminently hazardous situation that, if not avoided, will result in serious injury or death.



**WARNING** Indicates a hazardous situation that, if not avoided, could result in serious injury or death.



**CAUTION** Indicates a hazardous situation that, if not avoided, may result in minor or moderate injury.



**NOTICE** Indicates a potentially hazardous situation that, if not avoided, may result in property damage.

### 2.2. Basic Operator Safety, Responsibilities, & Qualifications

---



The safety information found throughout this complete Safety Section of the manual applies to all safety practices. Additional instructions specific to a certain safety practice (such as Operation Safety), can be found in the appropriate section.

**YOU** are responsible for the **SAFE** use and maintenance of your equipment. **YOU** must ensure that you and anyone else who is going to work around the equipment understands all procedures and related **SAFETY** information contained in this manual.

Remember, **YOU** are the key to safety. Good safety practices not only protect you, but also the people around you. Make these practices a working part of your safety program. All accidents can be avoided.

- It is the equipment owner, operator, and maintenance personnel's responsibility to read and understand **ALL** safety instructions, safety decals, and manuals and follow them when assembling, operating, or maintaining the equipment.
- Equipment owners must give instructions and review the information initially and annually with all personnel before allowing them to operate this product. Untrained users/operators expose themselves and bystanders to possible serious injury or death.
- This equipment is not intended to be used by children.
- Use this equipment for its intended purposes only.
- Do not modify the equipment in any way without written permission from the manufacturer. Unauthorized modification may impair the function and/or safety, and could affect the life of the equipment. Any unauthorized modification of the equipment will void the warranty.



## 2.3. Rotating Flighting

---

### **DANGER**

- KEEP AWAY from rotating flighting.
- DO NOT remove or modify flighting guards, doors, or covers. Keep in good working order. Have replaced if damaged.
- DO NOT operate the equipment without all guards, doors, and covers in place.
- NEVER touch the flighting. Use a stick or other tool to remove an obstruction or clean out.
- Shut off and lock out power to adjust, service, or clean.

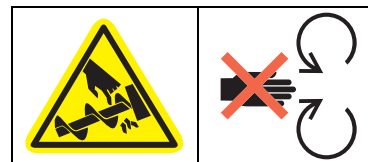

## 2.4. Work Area Safety

---

### **WARNING**

- Have another trained person nearby who can shut down the equipment in case of accident.
- The work area should be kept clear of bystanders.
- Keep the work area clean and free of debris.



## 2.5. Transport Safety

---

### **WARNING**

- Do not tow the transfer behind a vehicle, tires are not rated for highway transport.



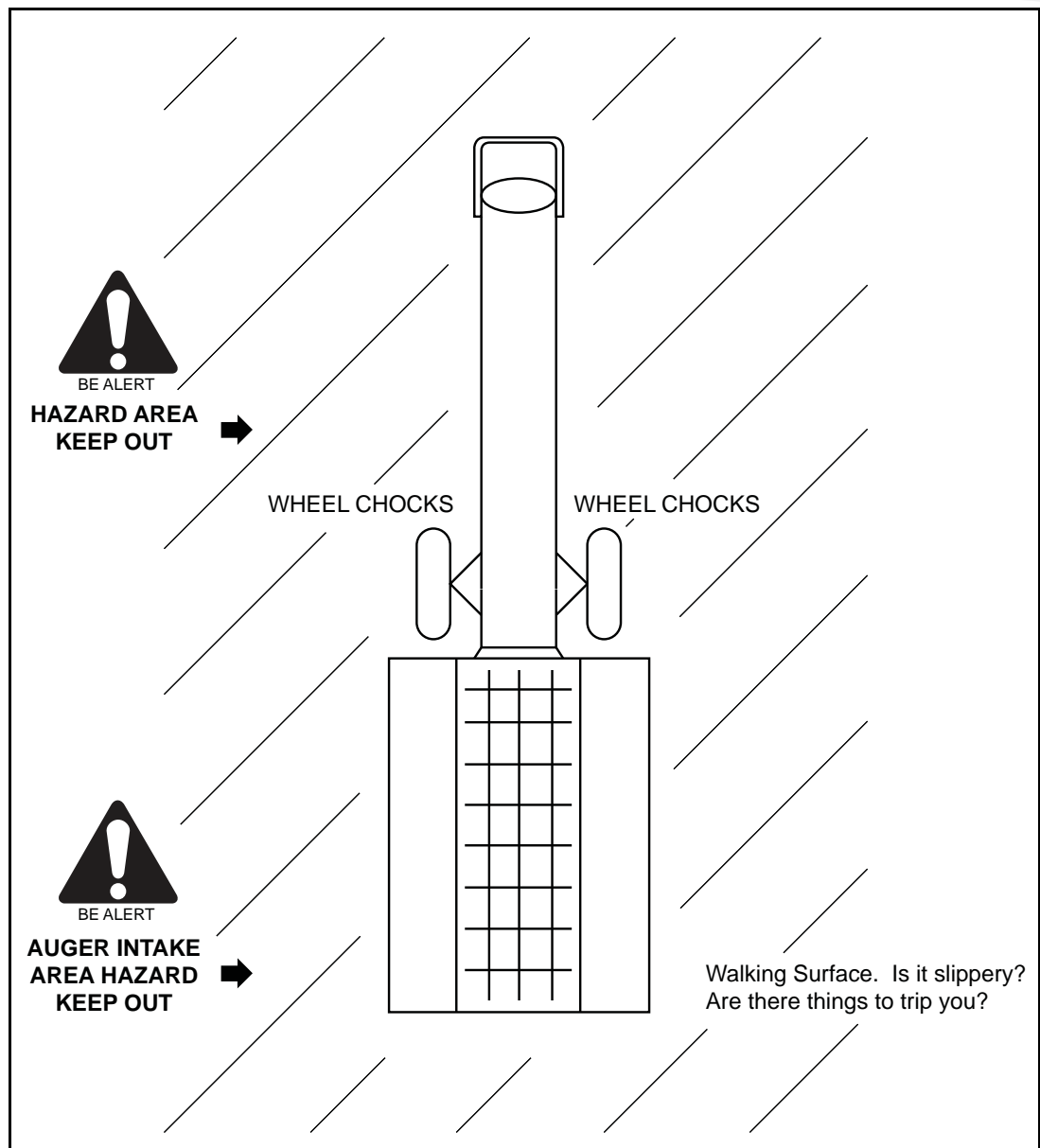

Figure 2.1 Work Area - Authorized Personnel Only

## 2.6. Drives and Lockout Safety

Inspect the power source(s) before using and know how to shut down in an emergency. Whenever you service or adjust your equipment, make sure you shut down and lock out your power source to prevent inadvertent start-up and hazardous energy release. Know the procedure(s) that applies to your equipment from the following power sources.

### 2.6.1. Hydraulic Power Safety

#### WARNING

##### Power Source

- Refer to the rules and regulations applicable to the power source operating your hydraulic drive.

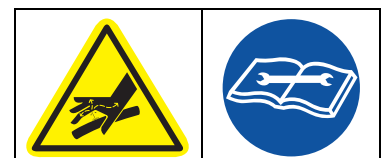

- Do not connect or disconnect hydraulic lines while system is under pressure.
- Keep all hydraulic lines away from moving parts.
- Escaping hydraulic fluid under pressure will cause serious injury if it penetrates the skin surface (serious infection or toxic reaction can develop). See a doctor immediately if injured.
- Use metal or wood as a backstop when searching for hydraulic leaks and wear proper hand and eye protection.
- Check all hydraulic components are tight and in good condition. Replace any worn, cut, abraded, flattened, or crimped hoses.
- Clean the connections before connecting to equipment.
- Do not attempt any makeshift repairs to the hydraulic fittings or hoses with tape, clamps, or adhesive. The hydraulic system operates under extremely high pressure; such repairs will fail suddenly and create a hazardous and unsafe condition.

#### Lockout

- Always place all hydraulic controls in neutral and relieve system pressure before disconnecting or working on hydraulic system.

## 2.7. Personal Protective Equipment

---

#### Safety Glasses

- Wear safety glasses at all times to protect eyes from debris.



#### Coveralls

- Wear coveralls to protect skin.



#### Hard Hat

- Wear a hard hat to help protect your head.



#### Steel-Toe Boots

- Wear steel-toe boots to protect feet from falling debris.



#### Work Gloves

- Wear work gloves to protect your hands from sharp and rough edges.



#### Dust Mask

- A dust mask may be needed to prevent breathing potentially harmful dust.



## 2.8. Safety Equipment

---

#### Fire Extinguisher

- Provide a fire extinguisher for use in case of an accident. Store in a highly visible and accessible place.



#### First-Aid Kit

- Have a properly-stocked first-aid kit available for use should the need arise, and know how to use it.



## 2.9. Safety Decals

---

- Keep safety decals clean and legible at all times.
- Replace safety decals that are missing or have become illegible. See decal location figures that follow.
- Replaced parts must display the same decal(s) as the original part.
- Replacement safety decals are available **free of charge** from your distributor, dealer, or factory.

### 2.9.1. Decal Installation/Replacement

---

1. Decal area must be clean and dry, with a temperature above 50°F (10°C).
2. Decide on the exact position before you remove the backing paper.
3. Align the decal over the specified area and carefully press the small portion with the exposed sticky backing in place.
4. Slowly peel back the remaining paper and carefully smooth the remaining portion of the decal in place.
5. Small air pockets can be pierced with a pin and smoothed out using the sign backing paper.

### 2.9.2. Safety Decal Locations and Details

---

Replicas of the safety decals that are attached to the equipment and their messages are shown in the figure(s) that follow. Safe operation of the equipment requires that you familiarize yourself with the various safety decals and the areas or particular functions that the decals apply to, as well as the safety precautions that must be taken to avoid serious injury, death, or damage.

Westfield reserves the right to update safety decals without notice. Safety decals may not be exactly as shown.

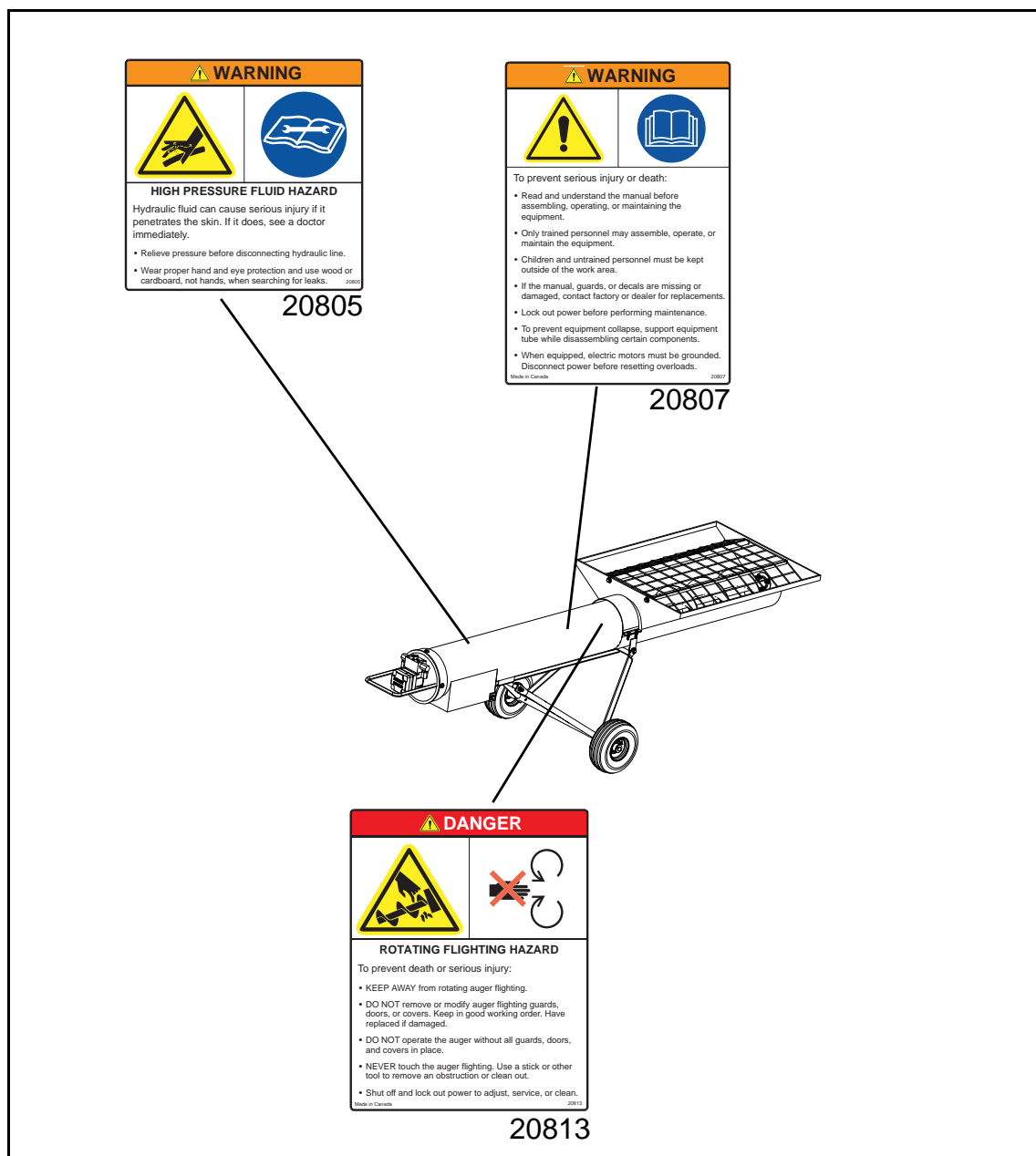

Figure 2.2 Safety Decals Locations

# 3. Operation



Before continuing, ensure you have completely read and understood this manual's Safety chapter, in addition to the safety information in the section(s) below.

## 3.1. Operating Safety

### WARNING

- Keep away from rotating auger flighting and moving parts, including drive components, shafts, and bearings.
- Always operate with guards, covers, and shields in place.
- Have another trained person nearby who can shut down the equipment in case of accident.
- The work area should be kept clear of bystanders.
- Place equipment on reasonably level ground before operating.
- Chock wheels after placement.
- Anchor intake end before using.
- Keep the work area clean and free of debris.
- Ensure maintenance has been performed and is up to date.



## 3.2. Transport Procedure

1. When transporting, place on a transport vehicle and tie down securely.

### WARNING

Do not tow the transfer behind a vehicle, tires are not rated for highway transport.

## 3.3. Placement Procedure

Follow this procedure when placing the transfer into its working position:

1. Be sure there is enough clearance from other equipment to move the transfer into its working position.
  2. Position the transfer under the truck or storage facility.
- Note:** The transfer is almost evenly balanced. Pushing down a little on the discharge end will raise the intake end off the ground and allow easy maneuvering.
3. Place chocks in the front and rear of each wheel.
  4. Position the next conveying system under the discharge and secure.

## 3.4. Transfer Spout Handle

---

1. Use the transfer spout handle to position the equipment.

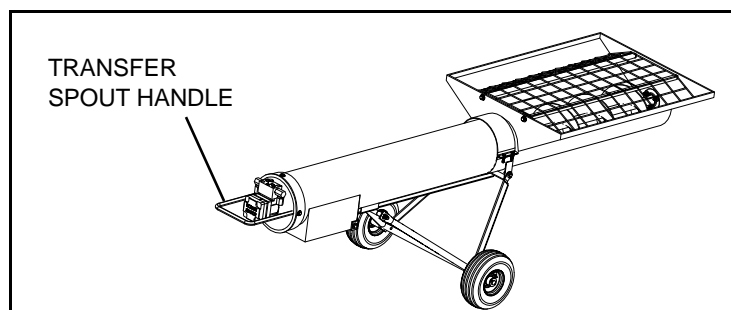

Figure 3.1 Transfer Spout Handle

## 3.5. Start-up and Break-In

---

Although there are no operational restrictions on the transfer when used for the first time, it is recommended that the following items be checked during the first hours of operation.

1. Check that the intake and discharge areas are free of obstructions.
2. Visually inspect the transfer, see Maintenance Section.
3. Be aware of unusual sounds. If any are heard, determine the source and stop the transfer. Lock out and correct the problem before resuming work.
4. Do not run the transfer for long periods of time without material in the transfer because it increases wear. Try to run only when moving material.
5. Ensure adequate power is being used to operate the transfer. Refer to the Specifications Section.

## 3.6. Operation - Hydraulic Drive

---



### When Equipped with a Hydraulic Drive

1. Inspect all hydraulic lines, hoses, fittings, and couplers for tightness. Use a clean cloth to wipe any accumulated dirt from the couplers before connecting to the hydraulic system of the tractor.
2. Position the tractor next to the transfer.
3. Place chocks in the front and rear of each wheel of the tractor, and be sure the hoses are routed out of the way.
4. Connect hydraulic hoses to the couplers.
5. Place all controls in neutral.
6. Start tractor and run at low idle.
7. Place hydraulic control lever in detent.
8. Increase engine speed to rated RPM to produce the required flow. For maximum recommended flow, refer to the Specifications Section.
9. Run until the transfer is fully empty.
10. Reduce engine speed to low idle.

11. Place hydraulic control lever in neutral.
12. Shut off tractor engine.

**Considerations when starting under load:**

Start at low speed if the transfer is under load (such as after an emergency shutdown), since the start-up torque loads are so much higher than normal when the hopper and tube are full.



**If equipped with a speed control valve:**

Adjust the flow of oil to the hydraulic motor as desired, see Figure 3.2.

- To stop the motor, turn the handle so it is parallel to the valve block.
- To run motor at full speed, position at right angles to the valve block.
- Set the handle between these 2 positions to run at partial speed.

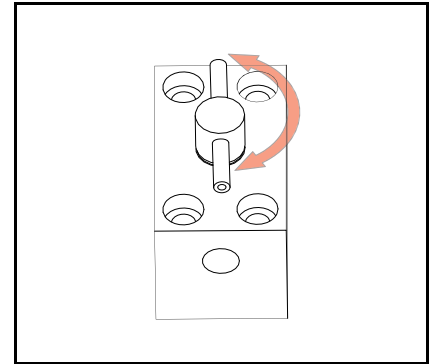

**Figure 3.2 Speed Control Valve**

## 3.7. Emergency Shutdown / Full-Tube Restart

Although it is recommended that the equipment run until hopper and tube are empty before stopping, in an emergency situation:

1. Stop or shut down the power source immediately and lockout power.
2. Correct the emergency before resuming work.
3. If the machine is shut down inadvertently or for an emergency, clear as much of the grain as possible before restarting.
4. With the power source locked out, remove as much of the grain as possible from the tube and intake using a piece of wood, vacuum cleaner, or other tool. Do not use your hands.

**NOTICE**

Starting under load may result in damage to the transfer if grain is not removed as much as possible.

## 3.8. Adjustable Auger Balance

The wheel position bracket is adjustable to allow the operator to set the machine balance. Use this setting to balance the machine when the power unit is installed. The best results are obtained when a downward force of 10 lb is required on the discharge end handle.

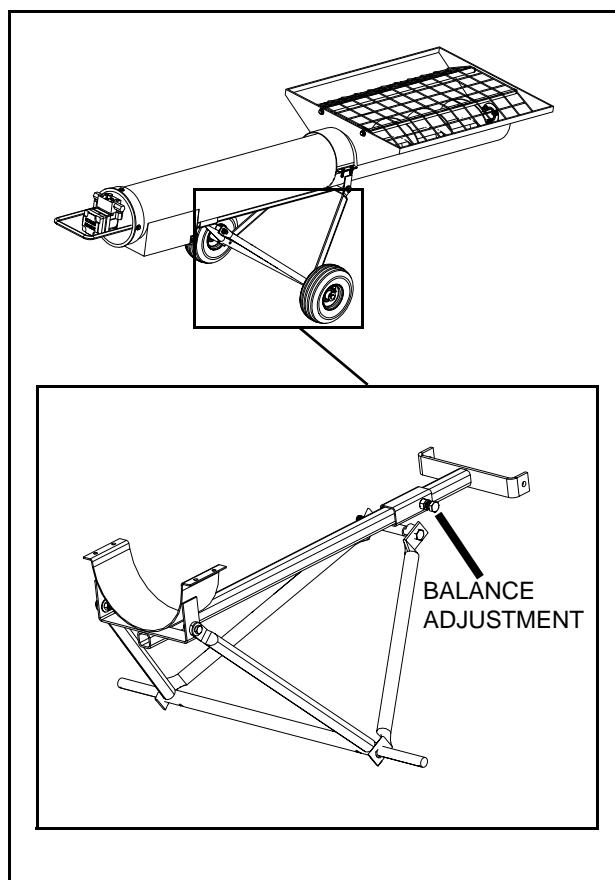

**Figure 3.3 Transfer Balance Adjustment**

## 3.9. Shutdown

---

When operation has been completed:

- Clean out any remaining grain from the transfer with a vacuum or sweep out.
- Clean entire work area.
- Remove anchors, supports, and chocks.

## 3.10. Storage

---

After the season's use, the transfer should be thoroughly inspected and prepared for storage. Repair or replace any worn or damaged components and perform Maintenance as described in the Maintenance Section to prevent any unnecessary downtime at the start of the next season.

To ensure a long, trouble-free life, this procedure should be followed when preparing the unit for storage.

1. Remove all residual material from the hopper and the tube.
2. Wash the entire transfer thoroughly using a water hose or pressure washer to remove all dirt, mud, debris, or residue.
3. Inspect all moving or rotating parts to see if anything has become entangled in them. Remove any entangled material.
4. Touch up all paint nicks and scratches to prevent rusting.



5. Inspect the transfer for cracks, tightness of fittings and fasteners, hydraulic hose cracks (if applicable). Have required repairs performed to replace worn or damaged components and complete required annual maintenance.
6. Store in an area that is dry, level, and free of debris. Chock wheels.
7. Check the tire pressure.
8. Store inside if possible. Cover with a waterproof tarpaulin if stored outside.



# 4. Maintenance



Before continuing, ensure you have completely read and understood this manual's Safety chapter, in addition to the safety information in the section(s) below.

## 4.1. Maintenance Safety

### WARNING

- Keep components in good condition. Follow the maintenance procedures.
- Do not modify any components without authorization from the manufacturer. Modification can be dangerous and result in serious injuries.
- After maintenance is complete, replace all guards, service doors, and/or covers.
- Use only genuine Westfield replacement parts or equivalent. Use of unauthorized parts will void warranty. If in doubt, contact the manufacturer or your local dealer.

Before attempting maintenance of any kind:

- Shut down and lock out power.
- Chock wheels.
- Support tube if performing maintenance on the undercarriage assembly.



- **If equipped with hydraulics:** Before applying pressure to a hydraulic system, make sure all components are tight and that hoses and couplings are in good condition.

## 4.2. Maintenance Schedule

Details of service are listed in Section 4.4.

	Every 8 Hours or Daily	Every 40 Hours or Weekly	Every 100 Hours or Annually	As Required
Visually inspect the unit.	x			
Clean machine.			x	
Grease machine.	x			

## 4.3. Fluids & Lubricants

### Storage & Handling

- Your equipment can operate at top efficiency only if clean fluids and lubricants are used. Use clean containers to handle all fluids and lubricants. Store them in an area protected from dust, moisture, and other contaminants.

### **Grease**

- Use SAE multi-purpose high-temperature grease with extreme pressure (EP) performance. SAE multi-purpose lithium-based grease is also acceptable.

## **4.4. Maintenance Procedures**

---

### **4.4.1. Visual Inspection**

---

Before beginning the visual inspection, chock auger wheels and ensure that all operators are aware of safety precautions.

When inspecting:

- Ensure all guards are in place, and in good working order.
- Examine the auger for damage or unusual wear.
- Inspect the machine for evidence of oil leaks.
- Examine hydraulic hoses and fittings for leaks and cracks.
- Be sure all safety decals are in place and are legible.
- ELECTRIC DRIVE: Check that drive belts are not frayed or damaged. Ensure they are properly adjusted and aligned.
- Check that the discharge spout and intake area are free of obstructions.
- Ensure that intake housing fasteners are properly secured.
- Examine all flighting for damage or unusual wear.
- Examine tires for gashes, uneven wear, or loss of air pressure.
- Inspect auger shaft bushing for unusual wear or discoloration.

Orientation of bushing will vary depending on model.

**Figure 4.1**

### **4.4.2. Clean Machine**

---

1. Lock out all power.
2. Clean out excess grain from auger tube and intake.
3. Make sure nothing is obstructing the auger intake so water can run out.
4. Wash the tube with a water hose or pressure washer until all dirt, mud, debris, or residue is washed from the auger.
5. Provide sufficient time for the water to drain from the auger.

### 4.4.3. Inspect Hydraulic Hose & Coupler

---

Using a piece of cardboard or wood, run it along the length of the hose and around all fittings. Replace the hose or tighten/replace the fitting if a leak is found.

**Note:** Hydraulic fluid can cause serious injury if it penetrates the skin. If it does, see a doctor immediately.

- Relieve pressure before disconnecting hydraulic line.
- Wear proper hand and eye protection and use wood or cardboard, not hands, when searching for leaks.



# 5. Troubleshooting



Before continuing, ensure you have completely read and understood this manual's Safety chapter, in addition to the safety information in the section(s) below.

This chapter covers possible causes and solutions to problems you may encounter. If you encounter a problem that is difficult to solve, even after having read this chapter, please contact your local Westfield dealer or distributor. Before contacting them, please have this operation manual and your machine's serial number handy.



## **WARNING**

Shut down and lock out all power sources before diagnosing any of the causes or attempting any of the solutions below.

Problem	Cause	Solution
The auger does not turn.	Auger is plugged or obstructed	Identify and remove obstruction
	Drive belt is slipping	Adjust the tension of the belt
	A bearing is seized	Identify the bearing and replace

Problem	Cause	Solution
The horizontal auger will not turn.	Center coupler bolt is broken or missing	Replace the bolt

Problem	Cause	Solution
Auger is noisy.	Obstruction in the auger	Identify and remove obstruction
	Auger shaft bolts are loose or damaged	Tighten or replace bolts
	Auger shaft is bent	Repair or replace auger
	Flighting is damaged	
	Worn bearing	Repair or replace bearing

Problem	Cause	Solution
Low material augering rate.	Engine speed is too slow	Increase rpm of the engine
	Inadequate material flow from truck or hopper	Increase flow of material
	Flow into the auger intake is restricted	Clear grating of obstructions
	Material too wet or heavy	Unloading rates are for dry grain
	Flighting is worn	Repair or replace as required





# 6. Appendix

## 6.1. Specifications

---

	9" Poly Transfer
Tube Size	9" (22.9 cm)
<b>CAPACITIES</b>	
Unloading Rate	Up to 5000 Bu/hr (176m3/hr)
<b>DIMENSIONS</b>	
Hopper Size	27" X 36" (68.6 cm X 91.4 cm)
Hopper Clearance	20" (50.8 cm)
Overall Length	8'4" (20.3 m)
Discharge Clearance	20" (50.8 cm)
<b>TIRES</b>	
Type	8"
Inflation Pressure	20 - 24 psi (137-165kPa)
<b>WEIGHT</b>	
Total Weight	140lb (63.8 kg)
<b>POWER REQUIREMENTS</b>	
Hydraulic Motor	4.6, 1/2NPTF



## Warranty

Westfield Industries Ltd. warrants products of its manufacture against defects in materials or workmanship under normal and reasonable use for a period of one year after date of delivery to the original purchaser.

Our obligation under this warranty is limited to repairing, replacing, or refunding defective part or parts which shall be returned to a distributor or a dealer of our Company, or to our factory, with transportation charges prepaid. This warranty does not obligate Westfield Industries Ltd. to bear the cost of labor in replacing defective parts. Any defects must be reported to the Company before the end of the one year period.

This warranty shall not apply to equipment which has been altered, improperly assembled, improperly maintained, or improperly repaired so as to adversely affect its performance. Westfield Industries Ltd. makes no express warranty of any character with respect to parts not of its manufacture.

The foregoing is in lieu of all other warranties, expressed or implied, including any warranties that extend beyond the description of the product, and the IMPLIED WARRANTY of MERCHANTABILITY is expressly excluded.

WESTFIELD INDUSTRIES LTD.

ROSENORT, MANITOBA

CANADA

R0G 1W0



P.O. Box 39

Rosenort, Manitoba, Canada R0G 1W0

Toll-Free: (866) 467-7207 (Canada & USA)

Phone: (204) 746-2396

Fax: (866) 768-4852

Email: [sales@grainaugers.com](mailto:sales@grainaugers.com)

Web: [www.grainaugers.com](http://www.grainaugers.com)

Westfield is part of the Ag Growth International group



© Ag Growth International Inc. 2015

Printed in Canada