



A503 Clump Buster Farm U-Trough Bin Unload System Installation Instructions

Applicable Models:

Westeel EasyFlow2 U-Trough Models

Preparation

1. Ensure bin is emptied.
2. Lock out power to the bin unload.
3. Reference your Westeel Farm U-Trough Bin Unload System Manuals and the Westeel Bin Manual for all other safety precautions.

Installation

Installing the Clump Buster Cages (Right and Left)

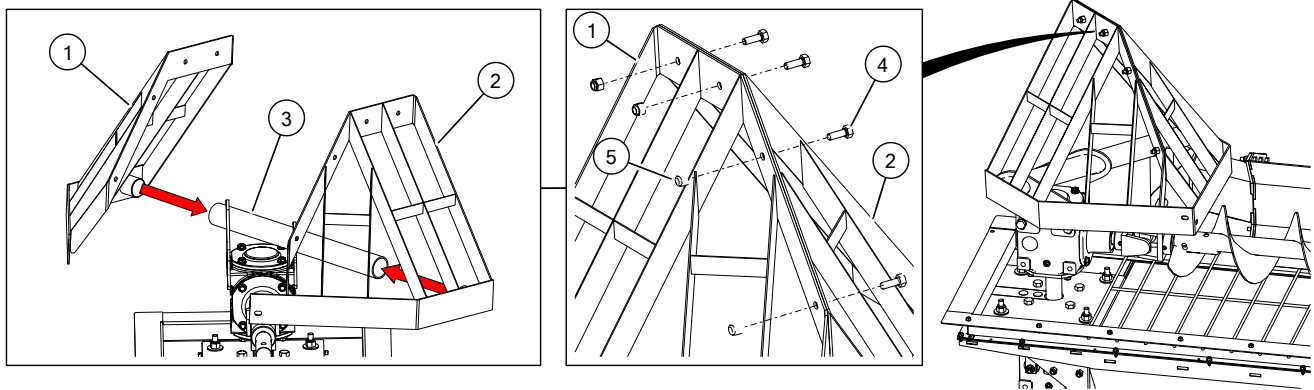

1	Clump Buster Cage, LH	4	Bolt, 3/8" x 1"
2	Clump Buster Cage, RH	5	Lock Nut, 3/8"
3	Backboard Mount Bracket		

Installing the Clump Buster Leg

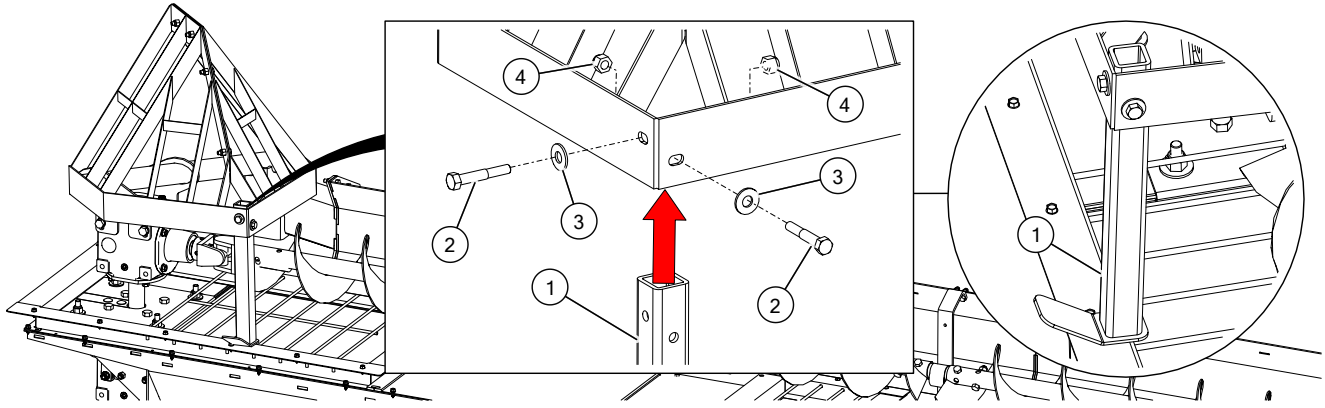

Assembly Note:

- Ensure the raised foot of the leg is facing away from the sweep (otherwise the leg may catch on the aeration floor as it rotates).

1	Clump Buster Leg	3	Flat Washer, 3/8"
2	Bolt, 3/8" x 2-1/4"	4	Lock Nut, 3/8"

Testing the Clump Buster

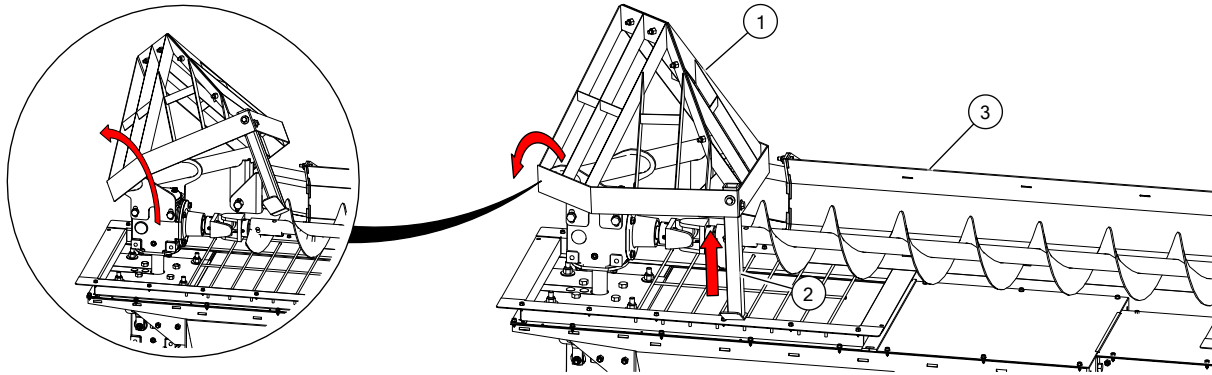

Assembly Notes:

- Test to see if the fully assembled clump buster can pivot up and down.
- Check that the clump buster leg does not interfere with anything by completing a test run of the sweep.

1	Clump Buster	3	Sweep
2	Clump Buster Leg		

AGI is a leading provider of equipment solutions for agriculture bulk commodities including seed, fertilizer, grain, and feed systems with a growing platform in providing equipment and solutions for food processing facilities. AGI has manufacturing facilities in Canada, the United States, the United Kingdom, Brazil, South Africa, India and Italy and distributes its products globally.



P.O. Box 39, Rosenort, Manitoba, R0G 1W0 Canada
P 866.467.7207 (Canada & USA) or 204.746.2396 | F 866.768.4852 | E sales@grainaugers.com

AGGROWTH.COM aggrowthintl
©Ag Growth International Inc. 2022 | Printed in Canada