

200067 Sweep Stop Kit Installation Instructions

1. Using the sweep stop as a template, mark and drill the four holes in the bin wall (1). The sweep stop should be positioned:
 - Far enough from the bin door so that it won't contact when opened.
 - High enough that the sweep end wheel fender will clear the sweep stop in its raised position. The bottom slot should be approximately 14"-16" from the top of the bin floor.
2. Line up the bottom mount holes of the rain hood (2) with the top holes previously drilled. Mark and drill the top mounting holes for the rain hood in the bin wall (1).
3. Mount the sweep stop (3) to the inside of the bin and the rain hood (2) on the outside of the bin using six 1/4" x 1" bolts (4), flat washers (6), sealing washers (5) and nylon locknuts (7).

Note

The top holes of the sweep stop (3), and the bottom holes of the rain hood (2) should be aligned and share hardware when mounting to the bin wall (1).

Figure 1. Install the Sweep Stop

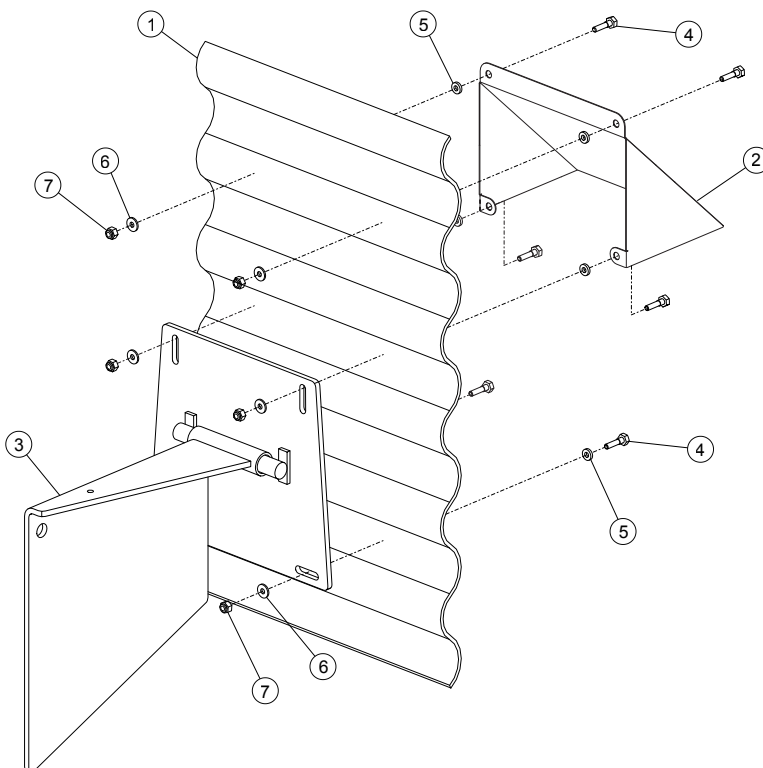

4. Measure 3–1/8" from the top of the sweep stop to mark and drill the hole for the cable. The hole should be as close to 1/8" in diameter as possible so the cable remains sealed.
5. Run one end of the cable through the top hole on the sweep stop , create a loop and secure with a cable clamp.
6. Route the other end of the cable through the hole in the bin wall.
7. Make a loop at the other end of the cable to create a handle and secure with a cable clamp.
8. Test the sweep stop and make any adjustments if necessary.
 - a. Allow the end wheel to contact the sweep stop to ensure it prevents the sweep from advancing.
 - b. Using the sweep stop cable outside of the bin, lift up the sweep stop to ensure the end wheel will clear it and perform a second pass.

Figure 2. Route the Cable

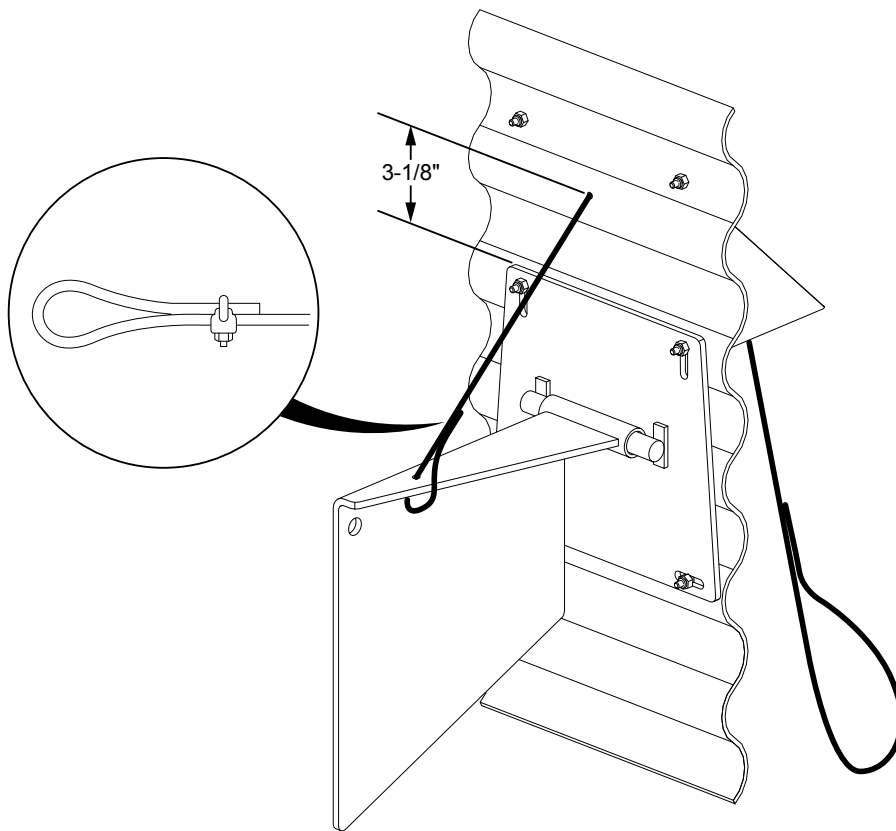

450 Desautels Street
 P.O. Box 792
 Winnipeg, Manitoba, R3C 2N5 Canada
 Phone: (866) 299-4312
 Fax: (204) 235-0796

Website: www.westeel.com
 Email: info@westeel.com
 ©Ag Growth International Inc. 2019, Printed in Canada