

# COMPACT HORIZONTAL CARTRIDGE (CHC) FILTER

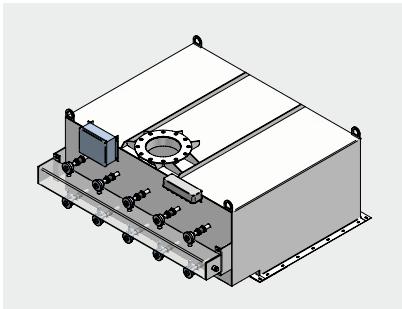

# Compact Horizontal Cartridge Filter

AGI Airlanco’s Compact Horizontal Cartridge (CHC) Filter is much smaller than traditional bag houses. The compact design is ideal when space is a concern. The CHC standard housing is rated for 20" W.C. All controls are factory mounted and tested on every unit prior to shipment to ensure premium product quality. Many different media types and sizes are available to fit your custom applications.



Style II filters are without hopper and structure. Custom discharge transitions are available per application upon request.

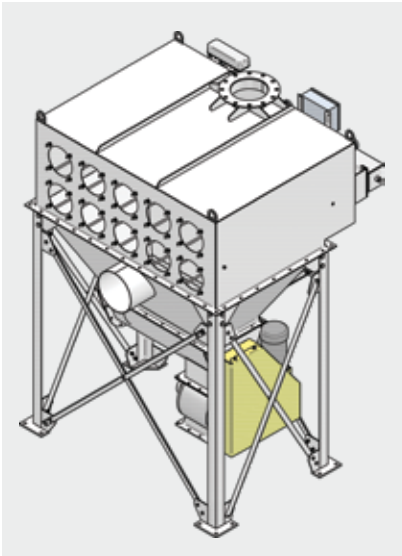

Style III filters are with hopper and optional stucture (shown with optional Airlock and/or Auger package).

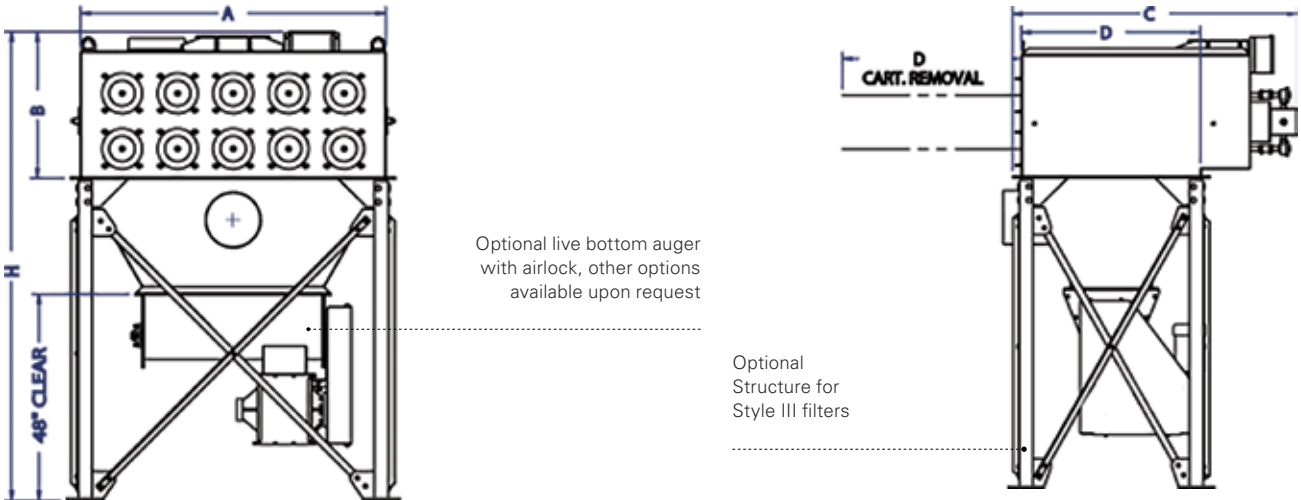

MODEL	MEDIA SF	CING CFM	A	B	C	D	H
202CHC18	132	1.78	34	32	42 5/8	18	101 3/8
203CHC18	198	2.67	46	32	42 5/8	18	101 3/8
204CHC18	264	3.56	58	32	42 5/8	18	101 3/8
205CHC18	330	4.46	70	32	42 5/8	101 3/8	101 3/8
202CHC28	212	2.86	34	32	52 5/8	28	101 3/8
203CHC28	318	4.29	46	32	52 5/8	28	101 3/8
204CHC28	424	5.72	58	32	52 5/8	28	101 3/8
205CHC28	530	7.16	70	32	52 5/8	28	101 3/8
202CHC40	300	4.05	34	32	64 5/8	40	101 3/8
203CHC40	450	6.08	46	32	64 5/8	40	101 3/8
204CHC40	600	8.10	58	32	64 5/8	40	101 3/8
205CHC40	750	10.13	70	32	64 5/8	40	101 3/8
202CHC55	400	5.40	34	32	79 5/8	55	101 3/8
203CHC55	600	8.10	46	32	79 5/8	55	101 3/8
204CHC55	800	10.80	58	32	79 5/8	55	101 3/8
205CHC55	1,000	13.50	70	32	79 5/8	55	101 3/8
206CHC55	1,200	16.20	76	32	64 5/8	55	101 3/8
208CHC55	1,600	21.60	100	32	64 5/8	55	101 3/8
210CHC55	2,000	27.00	124	32	64 5/8	55	101 3/8
403CHC55	1,200	16.20	46	56	79 5/8	55	125 3/8
404CHC55	1,600	21.60	58	56	79 5/8	55	125 3/8
405CHC55	2,000	27.00	70	56	79 5/8	55	125 3/8
406CHC55	2,400	32.40	77	56	79 5/8	55	125 3/8
408CHC55	3,200	43.20	101	56	79 5/8	55	125 3/8
410CHC55	4,000	54.00	125	56	79 5/8	55	125 3/8

- Notes
1. All dimensions are in inches.
  2. Designed for 20" W.C. operating pressure.
  3. Cleaning mechanism requires 60 PSIG of clean, dry air & a 110V power supply.
  4. Magnehelic differential pressure gauge kit is included.
  5. Standard finish is AGI Airlanco white or blue.
  6. See "B" dimension for style II bin vent over all heights.

- Applications**
- Bucket elevator aspiration
  - Belt conveyor transfer points
  - Blender/mixer ventilation
  - Silo/bin venting
  - Contact AGI Airlanco for special applications and for sizing information

- E-86 Cartridge**
- The CHC uses AGI Airlanco’s E-86 Cartridge, proven in the field since 1998. (U.S. Patent No. 5,803,939)
  - Spun bond polyester media, others available upon request
  - 190°F continuous operating temperature
  - Open pleat structure with wide pleat spacing to limit pleat pinching and bridging of product
  - Low differential pressure drop across media
  - High filtration efficiencies
  - Closed cell neoprene seals
  - Inner core structure for strength





**Airlanco is an AGI Brand.**

AGI is a leading provider of equipment solutions for agriculture bulk commodities including seed, fertilizer, grain, and feed systems with a growing platform in providing equipment and solutions for food processing facilities. AGI has manufacturing facilities in Canada, the United States, the United Kingdom, Brazil, India and Italy and distributes its products globally.

**AGI  AIRLANCO**

312 South Highway 73, PO BOX 398 Falls City, Nebraska USA 68355  
1.800.500.9777 | [sales@airlanco.com](mailto:sales@airlanco.com) | [aggrowth.com/airlanco](http://aggrowth.com/airlanco)

AGGROWTH.COM    [aggrowthintl](#)    [▶](#) [🐦](#) [in](#) [f](#) [o](#)

0920