



A252/A253 Hydraulic Hopper Lift Winch

The following manual is intended to assist with assembly of the A252 (MK 130) and A253 (MK 80/100) Hydraulic Hopper Lift Winch. This lift winch system can be combined with either a Hydraulic Powerswing (A205,A206,A207) or a Remote Powerswing (A232,A233,A234). To do this, assemble the Powerswing kit, excluding only the 17' long hydraulic hoses before following these instructions.

Step 1 Assemble Winch

First attach the winch(A) to the winch mount bracket(B) with three 3/8 x 1-1/4" bolts, 3/8" washers and 3/8" Locknuts. Just spin the nuts on by hand at this point, leaving them very loose. Be sure that the washers are used to secure the winch. On MK130 and SA13 Augers the winch mount bracket must be removed from the manual winch supplied with the auger, on all other models this kit will include the winch mount bracket.

Next, pin the winch mount bracket to the boot with the pin and clip supplied with the auger. This should be attached to the boot on the opposite side as the swing. Once the bracket is pinned in, tighten the 3/8" bolts securing the winch to the winch mount bracket.

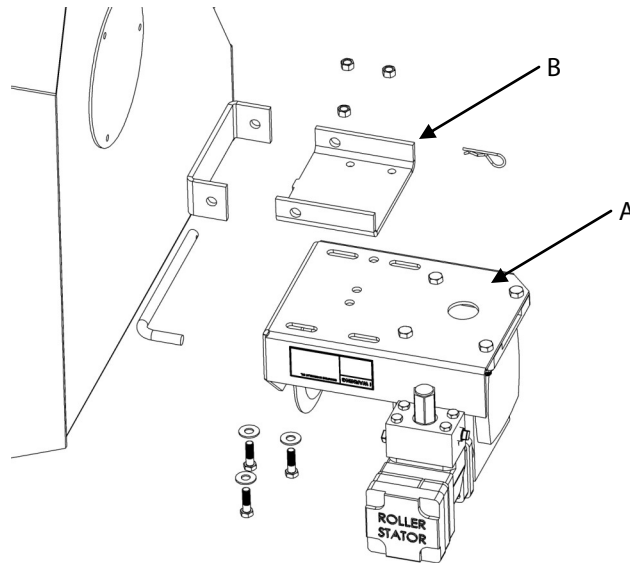

Figure 1

Step 2 Hydraulic Component Assembly

Before assembling the hydraulic fittings, be sure that you have Teflon tape or a thread sealant. Using that tighten in a 3/4" to 1/2" Bushing Reducer(E) into both the inlet and the outlet of the Hydraulic Valve(C). Next assemble part (F) into the Reducer just assembled. In your kit there will be two different parts that can act as part (F).

NOTE about open and closed loop hydraulics: If you plan on using the Hydraulic Hopper Lift Winch in conjunction with a Powerswing in a closed loop system, then part (F) will be a 1/2" FPT x 1/2" MPT x 1/2" FPT Street Tee. If the Hopper Lift will be used with a Powerswing in an open loop system or used by itself, then 1/2 MPT x 1/2 FPT Street Elbows should be used. It is best to tighten the fittings until they point the direction shown in figure 2. Fittings (D) should be installed later.

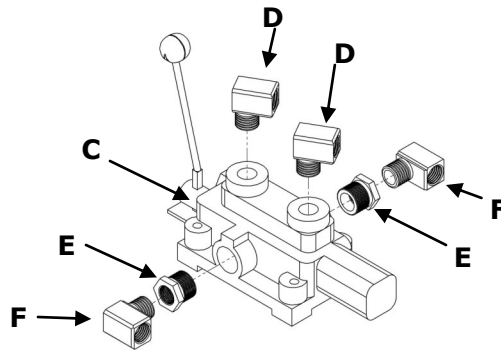

Figure 2

Next, attach the Hydraulic Valve Attach Plate(G) to the boot as shown in figure 3 with two 3/8" x 1-1/4" bolts. If you were supplied with any Hose Holders(H) use these bolts to secure them. Now bolt the Valve(C) to the Valve Mount Plate(I) using three 5/16" x 1-3/4" bolts and locknuts. Finally use the supplied Pin(J) and a Grip Clip to secure (I) to (G).

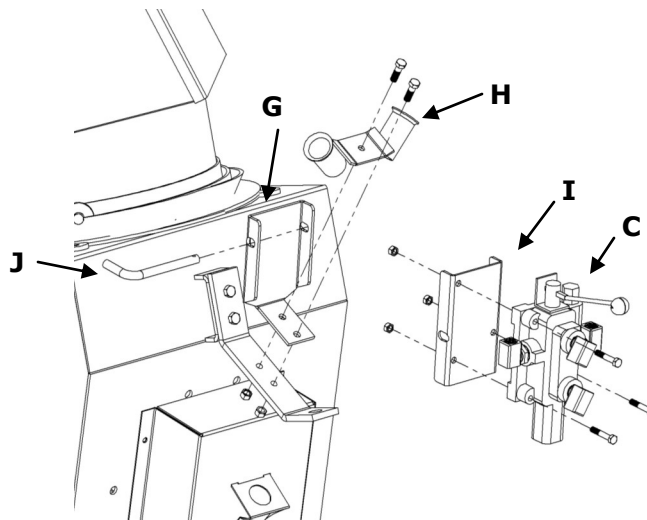

Figure 3

Now install the fittings labeled (D) from figure 2. These will be 1/2" MPT x 1/2" FPT Street Elbows. Install them pointing downward and towards the hydraulic winch.

Step 3 Hydraulic Hose Assembly

Combination Kits With Open Loop Hydraulics

Assemble hoses as shown in Figure 4. In this setup the valves are connected in series. Note connector(K) simply connects hose(L) to hose(M)

Combination Kits With Closed Loop Hydraulics

Assemble hoses as shown in Figure 5. In this setup the valves are connected in parallel. Note connector(K) is not needed. This will also involve using the plug supplied with each valve to close the center of the valve.

Hopper Lift Only

If the hopper lift is to be used without a powerswing companion then simply connect hoses (L) to the valve. The valve comes from the factory in open center configuration. It is shipped with a plug to close the center if needed.

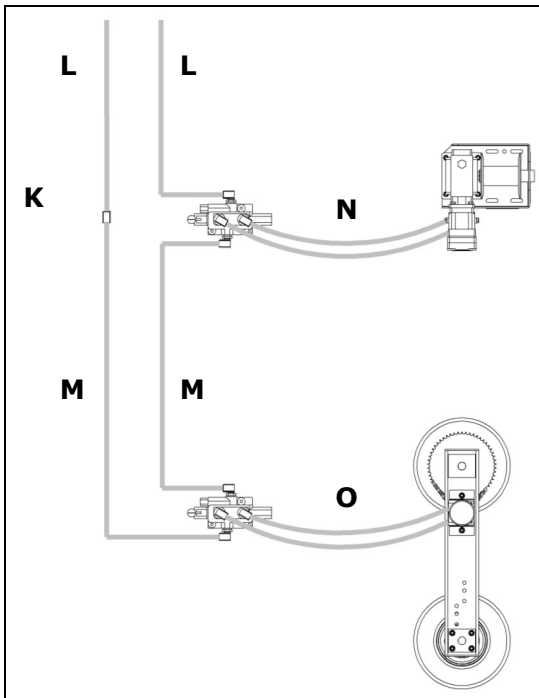

Figure 4

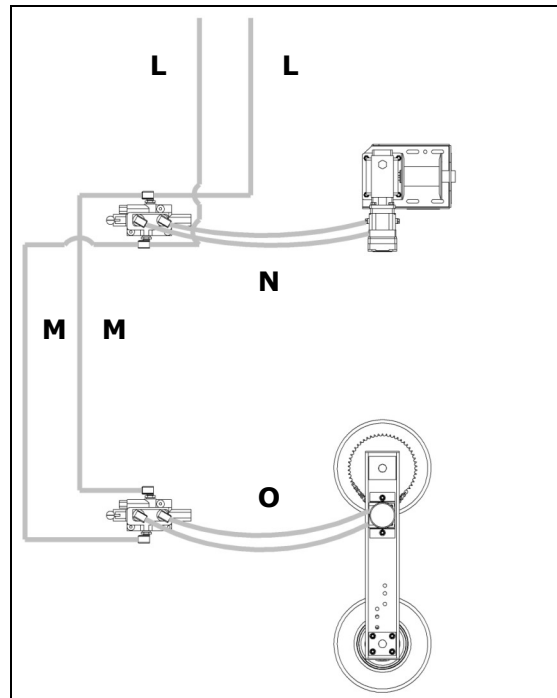

Figure 5

Part	13" Augers	8/10" Augers
K	1/2" NPT Connector (0102240)	1/2" NPT Connector (0102240)
L	1/2" x 72" (29394)	1/2" x 72" (29394)
M	1/2" x 136" (28244)	1/2" x 136" (28244)
N	1/2" x 64" (29393)	1/2" x 42" (29395)
O	3/8" x 38" (17710)	3/8" x 38" (17710)